

October 2007 Club Scrap®  
**Hometown Design  
Classics**

**Materials:**

- "Hometown" Design Classics Paper Pack

**Tools:**

- 12" Paper Trimmer
- Scissors
- Ruler
- Adhesive
- Black Ink

*Fraction to Decimal Conversions*  
 $1/8" = .125"$   $1/2" = .5"$   $7/8" = .875"$   
 $1/4" = .25"$   $5/8" = .625"$   
 $3/8" = .375"$   $3/4" = .75"$



**Layout #1 and #2**

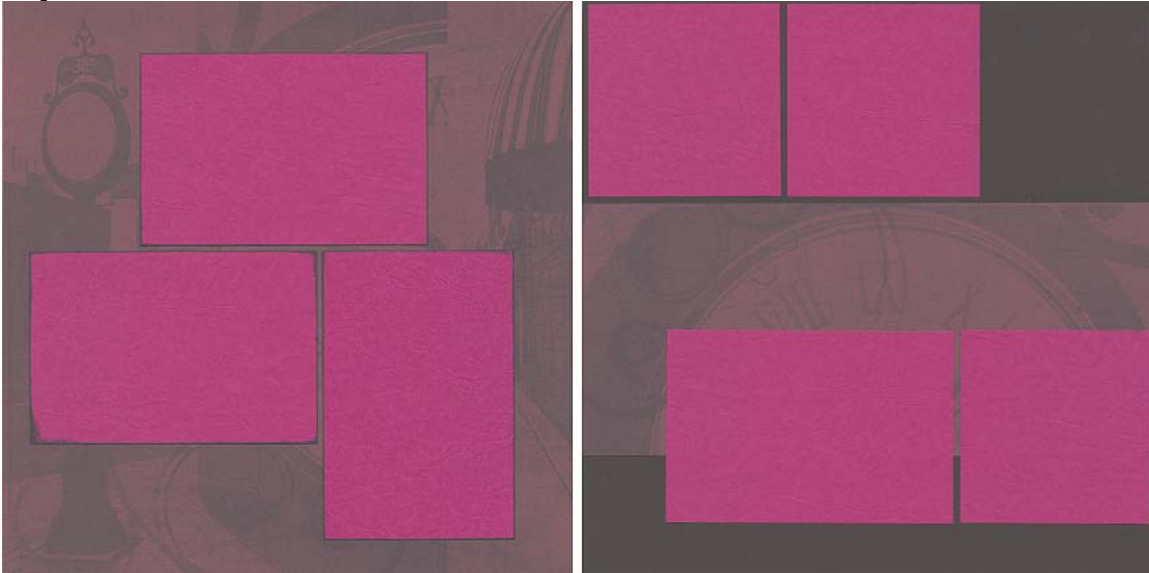

- (2) 12x12 Brick Print
- 12x12 Dark Brown Plain
- 12x12 Grape Plain

1. Trim the 12x12 Brick Print vertically along the pre-printed sections at 9.25 and 4".

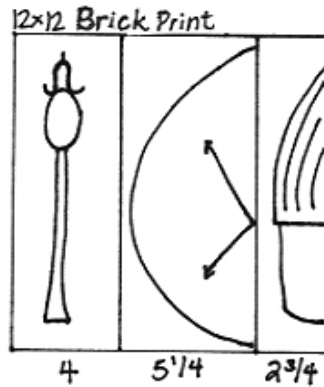

2. Cut the 12x12 Grape Plain at 8 and 4". Stack two 4x12 strips horizontally and trim in half at 6". Cut the remaining 4x12 horizontally at 8 and 4".

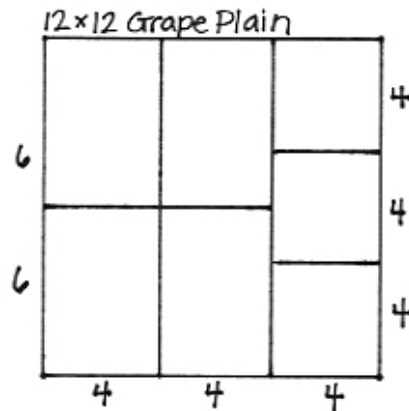

**Layout #3 and #4**



- 12x12 Light Raspberry “Women Laughing” Print
- 12x12 Grape “Shop Til’ You Drop” Print
- 12x12 Light Raspberry Plain
- 12x12 Brick Plain
- 4x12 Brick Print (From Layout #1 and #2) (Use plain side)

1. Trim the 12x12 Grape Print horizontally at 9.5, 7 and 6”. Rotate the 6x12 horizontally and cut at 8 and 4”. Use the plain side of one of the 4x6 you have just trimmed.

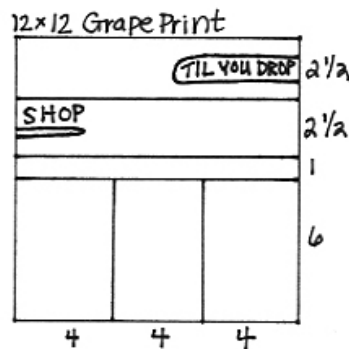

2. Cut the 12x12 Light Raspberry Print with the photo image on the left side of the trimmer at 7”. Trim the 5x12 horizontally at 9.5 and 7”. Stack the 2.5x5 strips horizontally and cut in half at 2.5” to make four 2.5” squares.

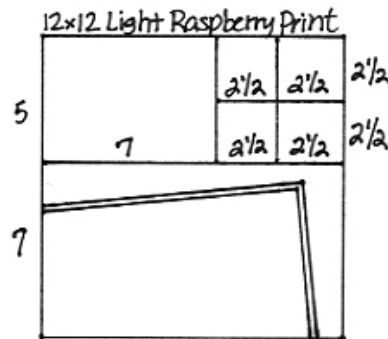

Layout #5 and #6



- (2) 12x12 Dark Brown Print
- 12x12 Light Raspberry "Home" Print
- 12x12 Light Raspberry Plain
- 7x12 Light Raspberry "Women Laughing" Print (From Layout #3 and #4)

1. Trim the 12x12 Dark Brown Print with "Neenah Foundry" on the left side of the trimmer at 11 and 7". Cut the 4x12 horizontally in half at 6".



2. Cut the 12x12 Light Raspberry "Home" Print, with the title square image on the lower right side of the trimmer, at 8.75 and 6.25". Rotate the 6.25x12 horizontally; trim at 8.5 and 4.25".

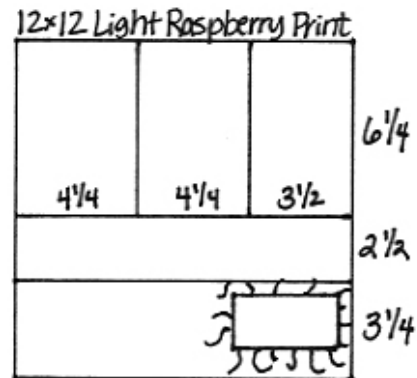

### Layout #7 and #8

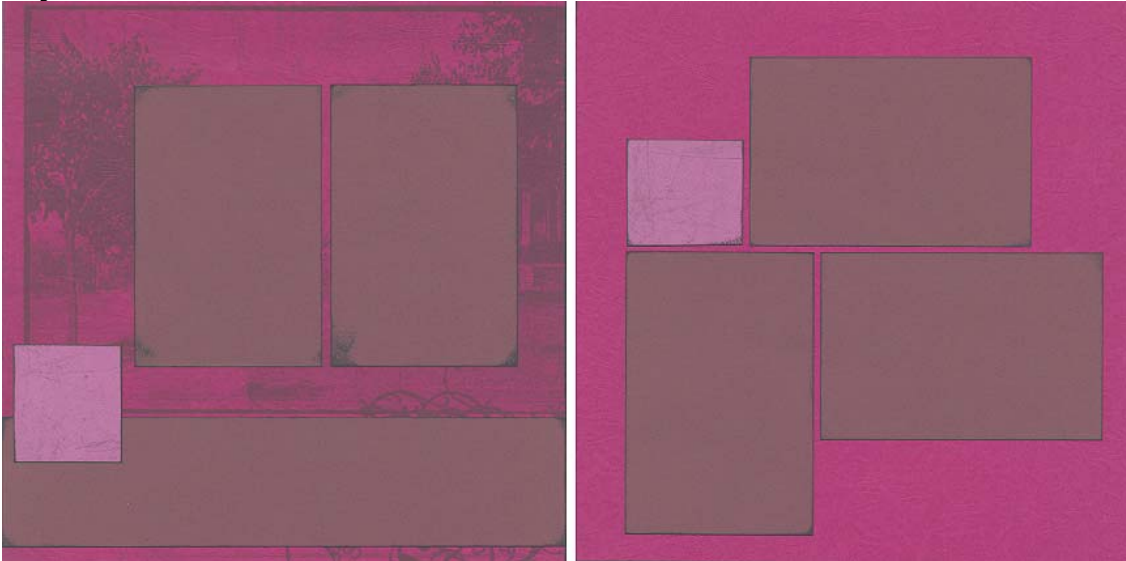

- 12x12 Grape "Home" Print
- 12x12 Grape Plain
- 12x12 Brick Plain
- (2) 2.5x2.5 Light Raspberry Print (From Layout #3 and #4)
- 2.75x12 Brick Print (From Layout #1 and #2)

1. Trim the 12x12 Brick Plain in half at 6". Stack and rotate; cut at 8 and 4". Trim one 4x6 horizontally at 4 and 2".

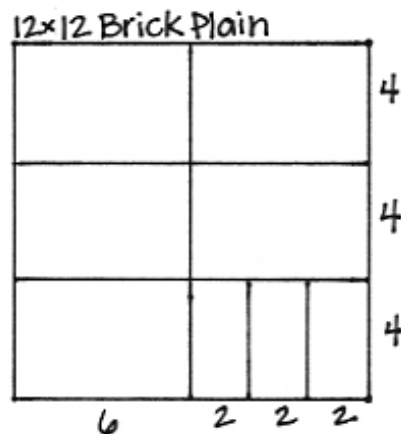

2. Use the plain side of the 2.75x12 Brick Print.



Layout #9 and #10



- 12x12 Grape “Women Laughing” Print
- 12x12 Grape “Shop Til’ You Drop” Print
- 12x12 Dark Brown Plain
- (3) 2x4 Brick Plain (From Layout #7 and #8)
- 1x12 Dark Brown Print Strip (From Layout #5 and #6)

1. Trim the 12x12 Grape “Shop Til You Drop” Print at 11, 8 and 4”. Stack each 4x12 horizontally and cut in half at 6”. Use the plain side of one 4x6 and also the 3x12 strip.

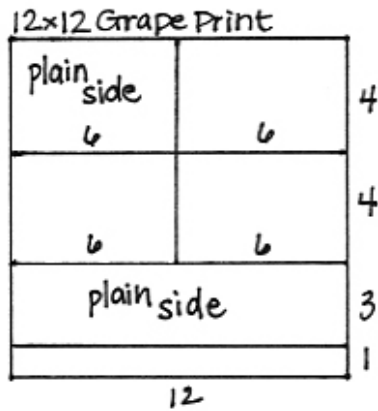

2. Use the plain side of the 1x12 Dark Brown Print strip.

