

Assembly Line Scrapbooking

December 2010 Silent Night

Materials:

- *Silent Night* Special Edition Collection
- *Silent Night* Unmounted Rubber

Tools and Supplies:

- 12" Paper Trimmer
- Adhesive
- CS® Grid Ruler
- CS® Onyx Ink

Measurement Conversions:

.25 = $\frac{1}{4}$ "
.5 = $\frac{1}{2}$ "
.75 = $\frac{3}{4}$ "

Notes: Trim the 12x12 White Cutparts into sections as indicated by the cutting guidelines.



Layout #1 and #2



- 12x12 Dark Grey Plain (LB)
- 12x12 Light Grey Print (RB)
- 12x12 White Plain
- 12x12 Brick Plain
- 8.5x11 White Print
- (2) 4.25x6.25 Black Photo Mattes
- (2) 4.25x6.25 Brick Photo Mattes
- White Cutaparts
- Unmounted Stamps

1. Using a grid ruler to measure and hold paper, tear two 1" strips from the edge of the 12x12 Brick Plain. Insert the 10x12 vertically into the trimmer with the torn edge at right. Cut at 9.25 and 6". Trim the 6x12 horizontally at 8 and 4". Cut the 3.25x12 horizontally at 11, 9.75, 6.5 and 3.25".

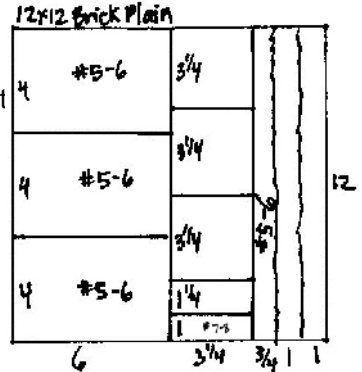

2. Cut the 8.5x11 White Print horizontally at 8.5 and 6". Trim the 6x8.5 horizontally at 8 and 4". Cut each 2.5x8 horizontally at 6 and 3.5".

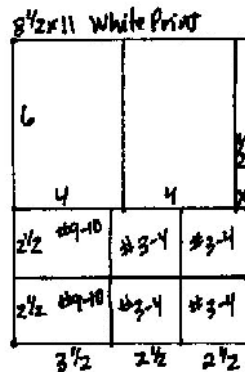

3. Trim the 12x12 White Plain at 6". Cut each 6x12 horizontally at 8 and 4".

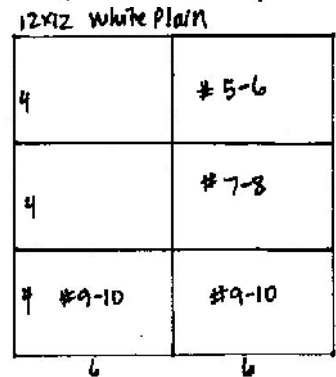

Layout #3 and #4



- (2) 12x12 White Prints (LB and RB)
- 8.5x11 Brick Plain
- 8.5x11 Black Plain
- (4) 2.5x2.5 White Prints (From #1-2)
- 4.25x6.25 Light Grey Photo Matte
- White Cutparts

1. Cut the 8.5x11 Brick Plain horizontally at 6".

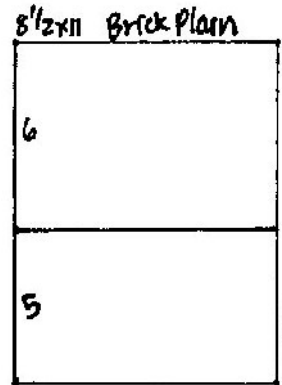

2. Trim the 8.5x11 Black Plain vertically at 7.25 and 4.5". Cut the 4.5x11 horizontally at 6.5". Trim the 4.5x4.5 at 3.25". Cut the 3.25x4.5 horizontally at 2.25". Trim the 2.75x11 horizontally at 8.25, 5.5 and 2.75". Cut the 1.25x11 horizontally at 6".

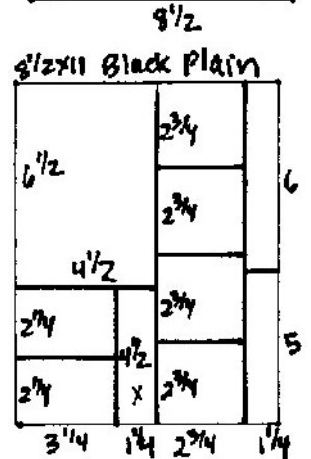

Layout #5 and #6



- 12x12 Black Print (LB)
- 12x12 Brick Plain (RB)
- 8.5x11 Light Grey Print
- (2) 4.25x6.25 Dark Grey Photo Mattes
- (3) 4x6 Brick Plains (From #1-2)
- .75x12 Brick Plain (From #1-2)
- 4x6 White Plain (From #1-2)
- White Cutparts

1. Place the 8.5x11 Light Grey Print horizontally and upside down into the trimmer. Cut at 8.5".

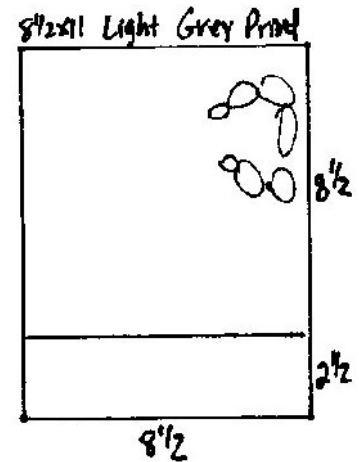

Layout #7 and #8



- 12x12 White Plain (LB)
- 12x12 Light Grey Print (RB)
- 8.5x11 Black Plain
- 8.5x11 Brick Plain
- 8.5x11 Light Grey Print

- 4.25x6.25 Dark Grey Photo Matte
- 4x6 White Plain (From #1-2)
- 1x3.25 Brick Plain (From #1-2)
- White Cutaparts

1. Trim the 8.5x11 Black Plain vertically at 6". Cut the 6x11 horizontally at 8 and 4". Trim one 4x6 horizontally at 5.75 and 4". Cut the 3x6 horizontally at 5.75 and 3".

2. Cut the 8.5x11 Brick Plain vertically at 6 and 4.25". Trim the 4.25x11 horizontally at 5.5". Cut the 1.75x11 horizontally at 9".

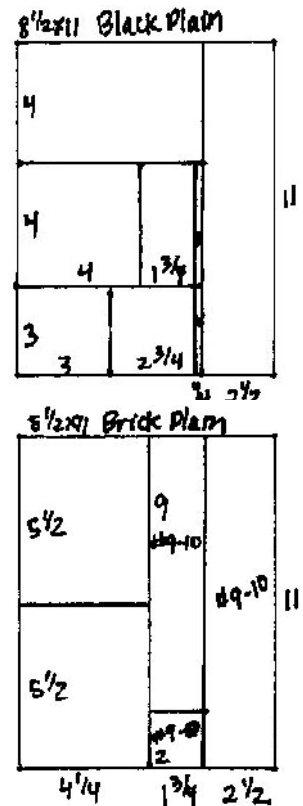

Layout #9 and #10



- 12x12 Dark Grey Plain (LB)
- 12x12 Black Print (RB)
- 8.5x11 White Print
- (2) 4.25x6.25 Light Grey Photo Mattes
- 4.25x6.25 Black Photo Matte
- 4.25x6.25 Brick Photo Matte
- (2) 4x6 White Plains (From #1-2)
- (2) 2.5x3.5 White Prints (From #1-2)
- 1.75x9 Brick Plain (From #7-8)
- 1.75x2 Brick Plain (From #7-8)
- 2.5x11 Brick Plain (From #7-8)
- White Cutaparts

1. Cut the 8.5x11 White Print vertically at 6.5".
2. The 1.75x9 and 1.75x2 Brick Plain pieces create the border on the bottom of the right page. The 2" piece is attach at the lower left and the 9" piece at lower right. The gap between the strips is hidden by the 12" Cutapart strip and journaling block.

