



Assembly Line Scrapbooking

Club Scrap® Sales Team Special Edition Sea and Sky

Materials:

- (3) 12x12 CS® Basics White Plain
- (3) 12x12 Birds of a Feather Periwinkle Plain
- 12x12 Birds of a Feather Buttercup Plain
- (3) 8.5x11 Birds of a Feather Periwinkle Plain
- (2) 8.5x11 Birds of a Feather Buttercup Plain
- 8.5x11 Solstice White Print
- 8.5x11 Birds of a Feather Buttercup Print
- 8.5x11 Poetic Yellow Right Print
- 8.5x11 Poetic Yellow Left Print
- (6) Birds of a Feather 3x5 Periwinkle Photo Mattes
- (6) Birds of a Feather 3x5 Buttercup Photo Mattes

Tools:

- 12" Paper Trimmer
- 3x13" CS Grid Ruler
- Adhesive
- Scissors
- CS® Sapphire Ink

Fraction to Decimal Conversions

$1/8" = .125"$ $1/2" = .5"$ $7/8" = .875"$

$1/4" = .25"$ $5/8" = .625"$

$3/8" = .375"$ $3/4" = .75"$



Layout #1 and #2



- (2) 12x12 White Plain (LB)
- 12x12 Periwinkle Plain (RB)
- 8.5x11 Yellow Left Print
- 8.5x11 Yellow Right Print
- 8.5x11 Periwinkle Plain
- (5) 3x5 Buttercup Photo Mattes

1. Trim the 12x12 White Plain at 9 and 6". Cut the 6x12 horizontally at 10, 8, and 4". Trim the 2x6 horizontally at 4 and 2".

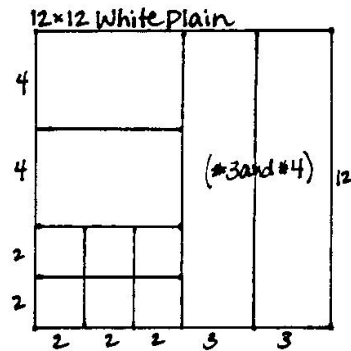

2. Cut the 8.5x11 Periwinkle Plain horizontally at 10.5 and 6.25". Trim the 6.25x8.5 horizontally at 4.25". Cut the 4.25x8.5 horizontally at 6.25".

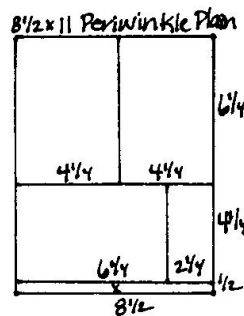

Layout #3 and #4

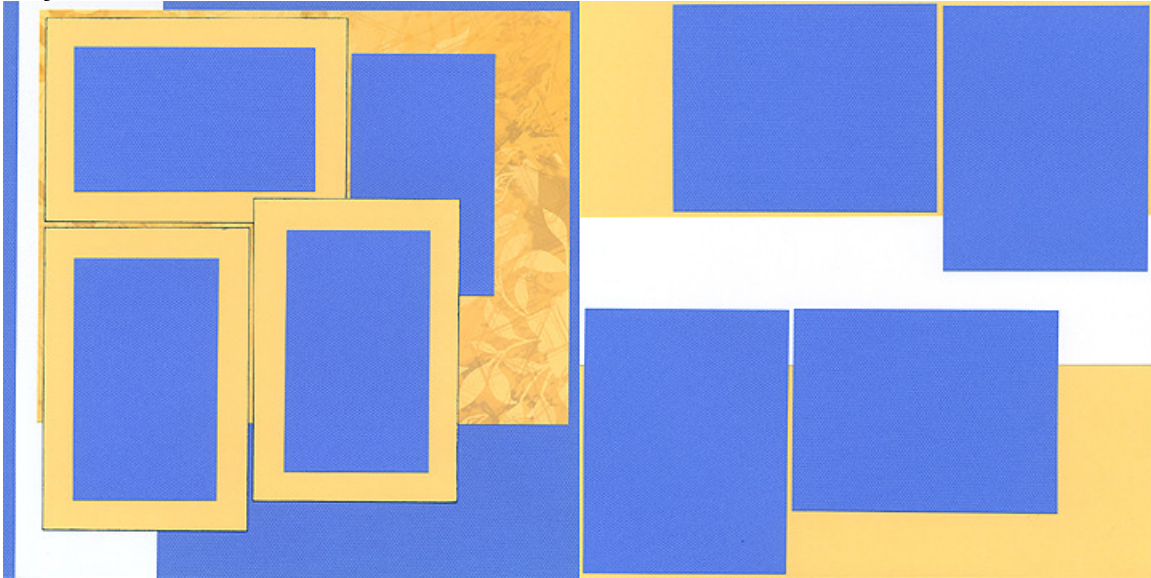

- 12x12 Periwinkle Plain (LB)
- 12x12 Buttercup Plain (RB)
- 8.5x11 Buttercup Print
- 8.5x11 Buttercup Plain
- 8.5x11 Periwinkle Plain
- (2) 3x12 White Plain (From #1 and #2)
- (4) 3x5 Periwinkle Photo Mattes
- CS® Sapphire Ink

1. Trim the 8.5x11 Buttercup Plain horizontally at 10.5 and 6.25". Cut the 6.25x8.5 horizontally at 4.25". Trim the 4.25x8.5 horizontally at 6.25".

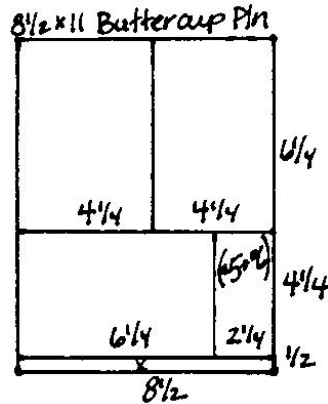

2. Cut the 8.5x11 Periwinkle Plain vertically at 4.25". Trim each 4.25x11 horizontally at 5.5".

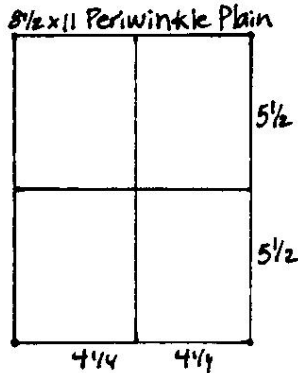

Layout #5 and #6

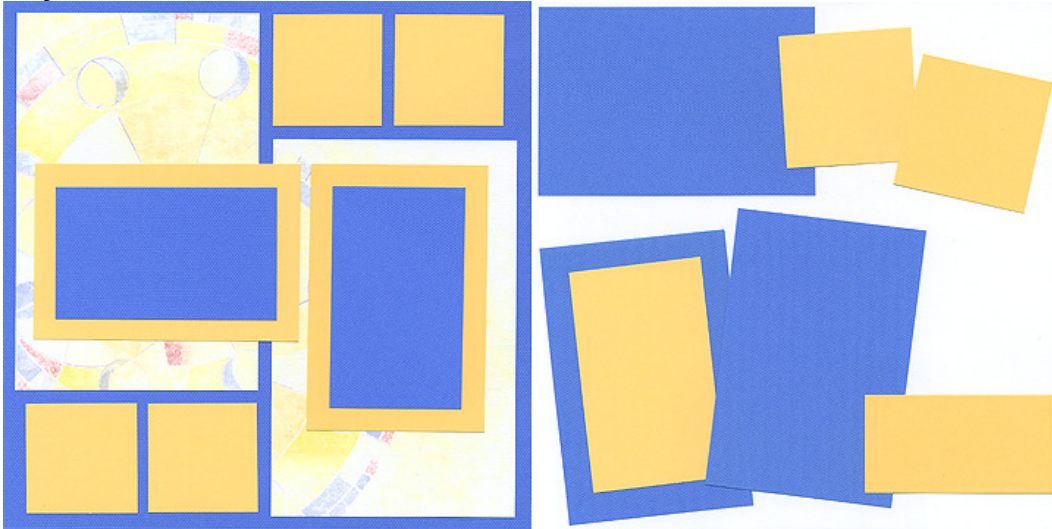

- 12x12 Periwinkle Plain (LB)
- 12x12 White Plain (RB)
- 8.5x11 White Print
- 8.5x11 Buttercup Plain
- 8.5x11 Periwinkle Plain
- 2.25x4.25 Buttercup Plain (From #3 and #4)
- (2) 3x5 Periwinkle Photo Mattes
- 3x5 Buttercup Photo Matte

1. Trim the 8.5x11 White Print horizontally at 5.5”.

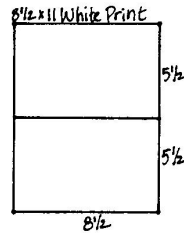

2. Cut the 8.5x11 Buttercup Plain vertically at 6”. Trim the 6x11 horizontally at 8 and 4”. Cut the 3x6 horizontally at 3”. Trim the 2.5x11 horizontally at 10, 7.5, 5, and 2.5”.

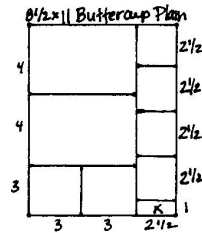

3. Trim the 8.5x11 Periwinkle Plain horizontally at 10.5 and 6.25”. Cut the 6.25x8.5 horizontally at 4.25”. Trim the 4.25x8.5 horizontally at 6.25”.

