

Assembly Line Scrapbooking

Club Scrap® Sales Team Special Edition Playtime

Materials:

- (2) 12x12 Matrix Yellow Grid Print
- 12x12 Gratitude Red Print
- 12x12 Matrix Yellow Circle Print
- 12x12 Matrix Brown Print
- 12x12 CS® Basics White Plain
- 12x12 Chapter One Dark Red Plain
- 12x12 Great Outdoors Light Red Plain
- (2) 8.5x11 Matrix White Print
- (2) 8.5x11 CS® Basics White Plain
- 8.5x11 Matrix Brown Print
- 8.5x11 Gratitude Handmade Red
- 8.5x11 Chapter One Dark Red Plain
- 8.5x11 Matrix Blue Plain
- Matrix Die Cuts

Tools:

- 12" Paper Trimmer
- 3x13" CS Grid Ruler
- Adhesive
- Scissors

Fraction to Decimal Conversions

$1/8" = .125"$ $1/2" = .5"$ $7/8" = .875"$

$1/4" = .25"$ $5/8" = .625"$

$3/8" = .375"$ $3/4" = .75"$



Layout #1 and #2

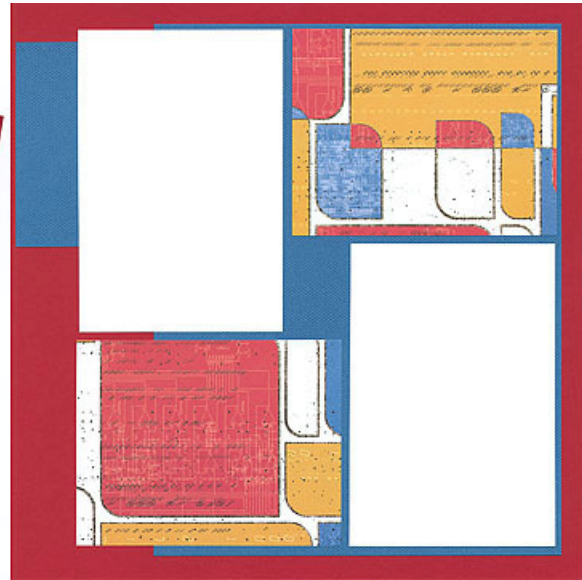

- 12x12 White Plain (LB)
- 12x12 Dark Red Plain (RB)
- 8.5x11 White Print

- 8.5x11 Blue Plain
- 8.5x11 White Plain
- 8.5x11 Dark Red Plain

1. Trim the 8.5x11 White Print horizontally at 5.5". Cut the one 5.5x8.5 horizontally at 4.25".
2. Cut the 8.5x11 Dark Red Plain horizontally at 10.5 and 6.25". Trim the 6.25x8.5 horizontally at 4.25". Cut the 4.25x8.5 horizontally at 6.25".
3. Trim the 8.5x11 White Plain horizontally at 10.5 and 6.25". Cut the 6.25x8.5 horizontally at 4.25". Trim the 4.25x8.5 horizontally at 6.25".

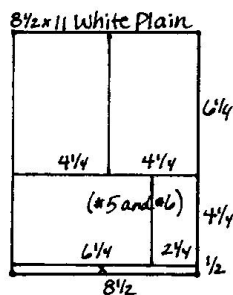
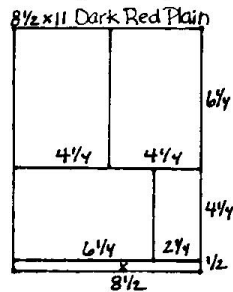
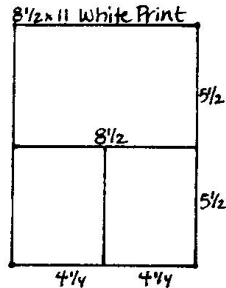

Layout #3 and #4

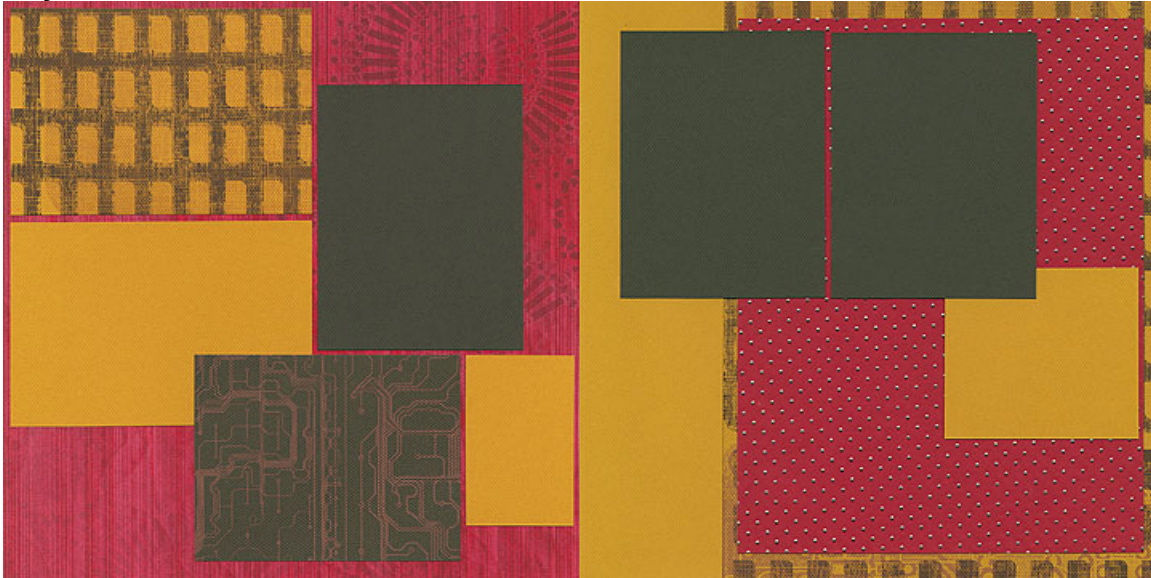

- 12x12 Red Print (LB)
- (2) 12x12 Yellow Grid Print (RB)

- 8.5x11 Brown Print
- 8.5x11 Handmade Red

1. Trim one 12x12 Yellow Grid Print at 9 and 6.25". Cut the 6.25x12 horizontally at 8.5 and 4.25". Trim the 3.5x6.25 horizontally at 4".

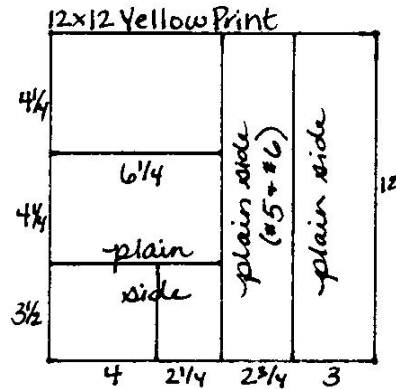

2. Cut the 8.5x11 Brown Print vertically at 4.25". Trim the 4.25x11 horizontally at 5.5".

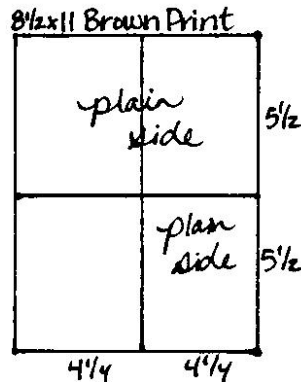

Layout #5 and #6

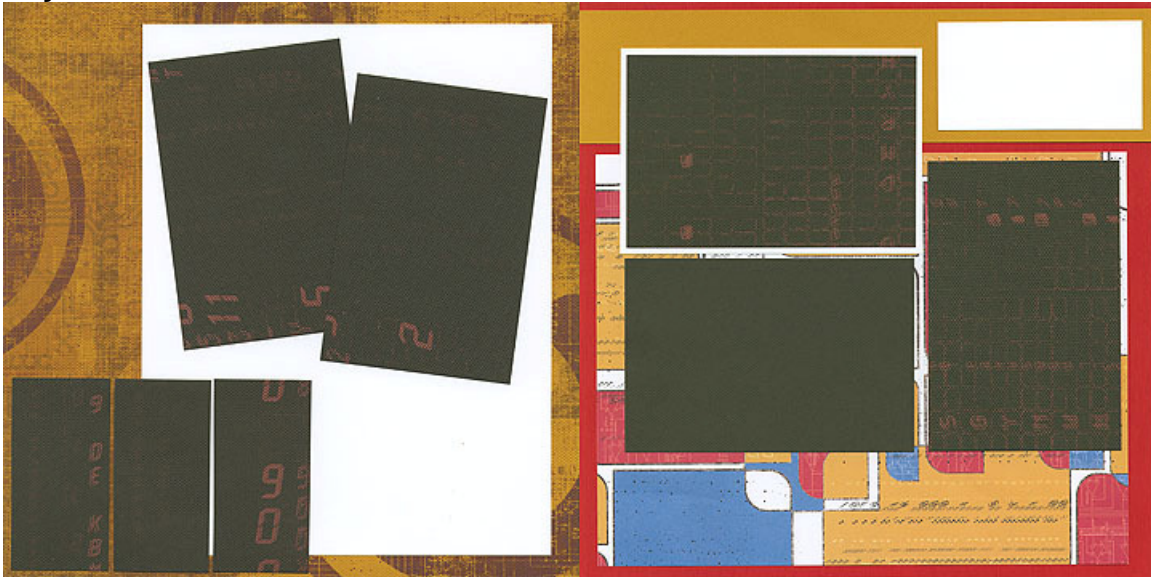

- 12x12 Yellow Circle Print (LB)
- 12x12 Light Red Plain (RB)
- 12x12 Brown Print
- 8.5x11 White Print
- 8.5x11 White Plain
- 4.25x6.25 White Plain (From #1 and #2)
- 2.75x12 Yellow Print (From #3 and #4)
- 2.25x4.25 White Plain (From #1 and #2)

1. Trim the 12x12 Brown Print at 6". Cut each 6x12 horizontally at 8 and 4". Trim one 4x6 horizontally at 4 and 2".

