

2010 Club Scrap®  
**Michael Strong Origami**  
**“Metropolitan”**

**Materials:**

- Michael Strong's Origami “Metropolitan”* Collection

**Tools and Supplies:**

- Paper Trimmer
- Adhesive
- CS® Grid Ruler

*Measurement Conversions:*

.25 =  $\frac{1}{4}$ "

.5 =  $\frac{1}{2}$ "

.75 =  $\frac{3}{4}$ "



**Layout #1 and #2**



- 12x12 Teal Print (Base L)
- 12x12 Brown Plain (Base R)
- 8.5x11 Brown Plain
- 8.5x11 Teal Print

1. Cut the 8.5x11 Brown Plain vertically at 5". Trim the 5x11 horizontally at 7". Cut the 3.5x11 horizontally at 10.5, 7, and 3.5".

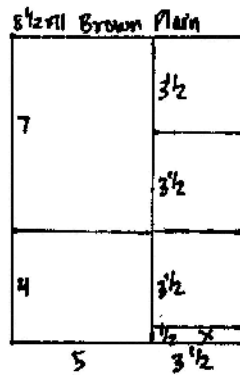

2. Trim the 8.5x11 Teal Print vertically at 4.25". Cut each 4.25x11 horizontally at 5.5".

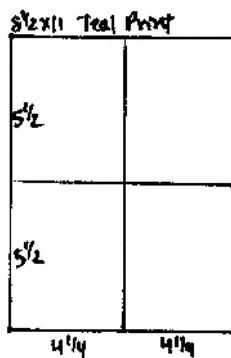

Layout #3 and #4



- 12x12 Light Pink Print (Base L)
- 12x12 Teal Plain (Base R)
- 8.5x11 Light Pink Print
- 8.5x11 Teal Plain

1. Cut the 8.5x11 Light Pink Print horizontally at 10, 8 and 4". Trim one 4x8.5 horizontally at 6". Cut the other 4x8.5 horizontally at 8 and 4". Trim the 2x8.5 horizontally at 8 and 4".

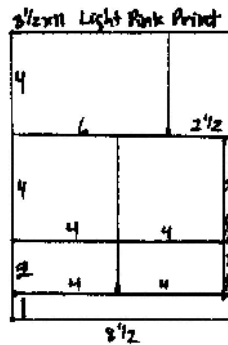

2. Trim the 8.5x11 Teal Plain horizontally at 10.5 and 6.25". Cut the 6.25x8.5 horizontally at 4.25". Trim the 4.25x8.5 horizontally at 6.25". Cut the 2.25x4.25 horizontally at 3.75".

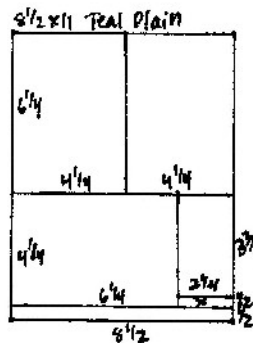

**Layout #5 and #6**



- 12x12 Dark Pink Print (Base L)
- 12x12 White Print (Base R)
- 8.5x11 White Plain
- 8.5x11 Dark Pink Print

1. Cut the 8.5x11 White Plain vertically at 6". Trim the 6x11 horizontally at 8 and 4". Cut the 3x6 horizontally at 3". Trim the 2.5x11 horizontally at 10, 7.5, 5, and 2.5".

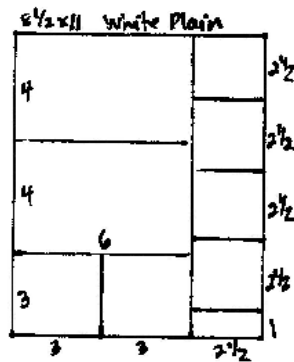

2. Trim the 8.5x11 Dark Pink Print vertically at 4.25". Cut one 4.25x11 horizontally at 5.5".

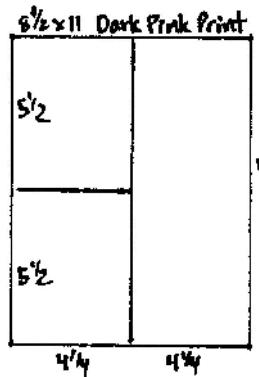



Layout #7 and #8



- 12x12 Light Pink Print (Base L)
- 12x12 Teal Print (Base R)
- 8.5x11 Teal Print
- 8.5x11 Dark Pink Print

1. Cut the 8.5x11 Teal Print vertically at 7". Trim the 7x11 horizontally at 10 and 5".

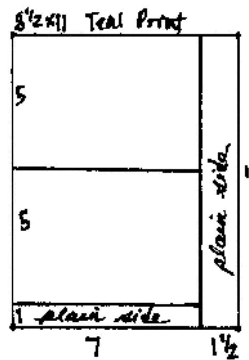

2. Trim the 8.5x11 Dark Pink Print horizontally at 10.5 and 6.25". Cut the 6.25x8.5 horizontally at 4.25". Trim the 4.25x8.5 horizontally at 6.25".

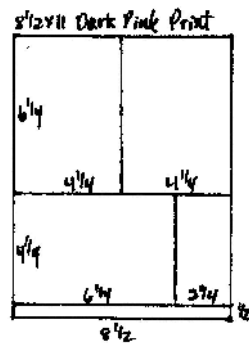

**Layout #9 and #10**



- 12x12 Dark Pink Plain (Base L)
- 12x12 White Plain (Base R)
- 8.5x11 White Print
- 8.5x11 Light Pink Print

1. Trim the 8.5x11 White Print horizontally at 10 and 5". Cut one 5x8.5 horizontally at 4.25". Trim the other 5x8.5 horizontally at 7". Cut the 1.5x5 horizontally at 4.5, 3 and 1.5". Trim the 1x8.5 horizontally at 5".

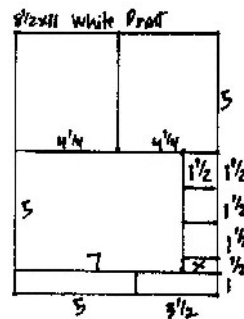

2. Cut the 8.5x11 Light Pink Print vertically at 4.25". Trim each 4.25x11 horizontally at 5.5".

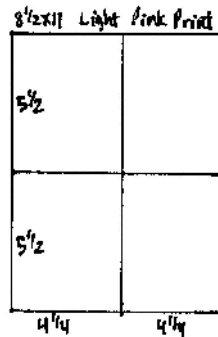

Layout #11 and #12



- 12x12 Brown Print (Base L)
- 12x12 Dark Pink Print (Base R)
- 8.5x11 Dark Pink Plain
- 8.5x11 Brown Print

1. Cut the 8.5x11 Dark Pink Plain horizontally at 10.5 and 6.25". Trim the 6.25x8.5 horizontally at 4.25". Cut the 4.25x8.5 horizontally at 6.25". Trim the .5x8.5 horizontally at 6".

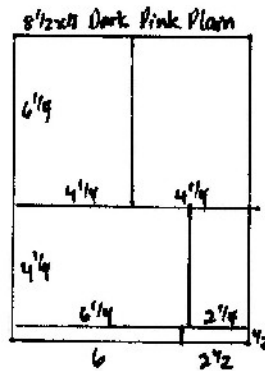

2. Trim the 8.5x11 Brown Print horizontally at 6". Cut the 6x8 horizontally at 8 and 4". Trim the 5x8.5 horizontally at 4.25". Cut the .5x6 horizontally at 4.25".

