

June 2010 Club Scrap® Faith Expressions

Materials:

- Faith Expressions* Collection
- Faith Expressions* Unmounted Borders & Backgrounds

Tools and Supplies:

- Paper Trimmer
- Adhesive
- Foam Tape
- Bone Folder
- Craft Knife and Cutting Mat
- CS® Grid Ruler
- CS® Earth and Sandstone Ink
- Solstice Crystal Brad (Optional)
- (6) Mini Brads



Layout #1 and #2



- 12x12 Gray Print (L Base)
- 12x12 Ivory Plain (R Base)
- 8.5x11 Ivory Text Print
- 8.5x11 Ivory Plain

- (2) 4.25x6.25 Grey Photo Mattes
- Ivory Text Cutaparts
- Ivory Text Die Cuts
- Ivory Die Cuts

1. Free-hand cut the 8.5x11 Ivory Text Print with a craft knife and cutting mat.

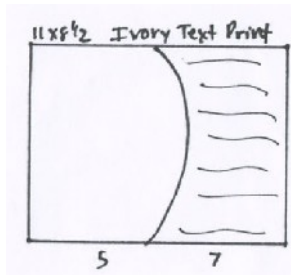

2. Trim the 8.5x11 Ivory Plain horizontally at 8.25 and 5.5". Cut the 5.5x8.5 horizontally at 4.25". Trim each 2.75x8.5 horizontally at 8.25, 5.5 and 2.75".

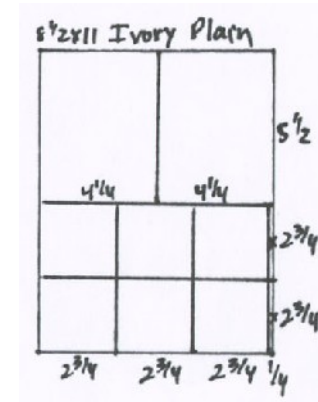

Layout #3 and #4



- 12x12 Ivory Text Print (L Base)
- 12x12 Gray Plain (R Base)
- 12x12 Ivory Print
- 8.5x11 Gray Print
- (2) 4.25x6.25 Ivory Text Photo Mattes

- (2) 4.25x6.25 Taupe Photo Mattes
- (4) 4 2.75x2.75 Ivory Plain (From #1-2)
- Ivory Die Cuts
- Ivory Text Cutaparts

1. Cut the 12x12 Ivory Print at 4.5".

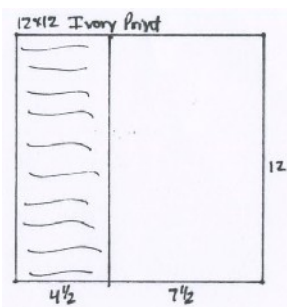

2. Place the 8.5x11 Gray Print upside down and vertically into the trimmer; cut at 8 and 6.5".

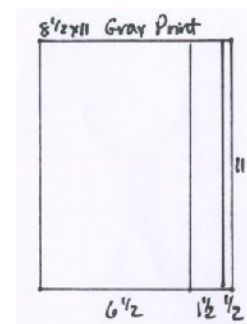

Layout #5 and #6

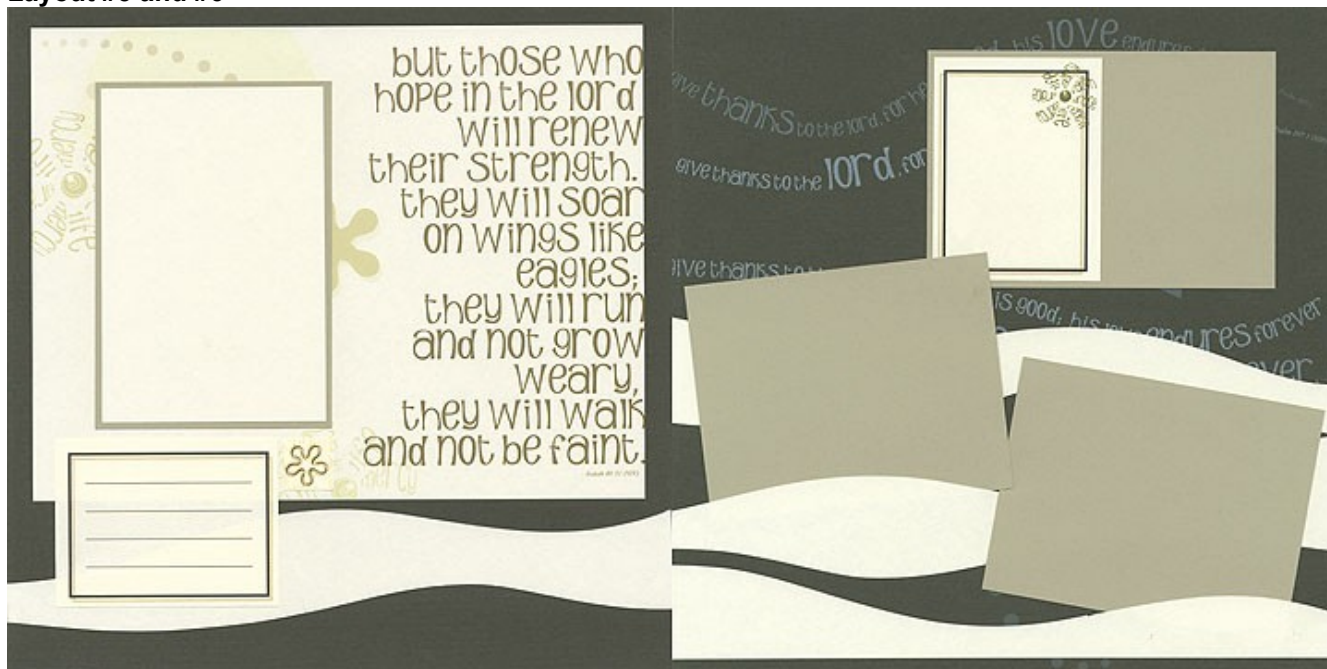

- 12x12 Gray Plain (L Base)
- 12x12 Gray Print (R Base)
- 8.5x11 White Text Print
- 12x12 Ivory Text Plain
- 8.5x11 Taupe Plain
- Ivory Text Cutaparts
- Ivory Text Die Cuts

1. Trim the 12x12 Ivory Text Plain at 6". Cut one 6x12 horizontally at 8 and 4". Cut the remaining 6x12 vertically into wavy strips with a craft knife and cutting mat.

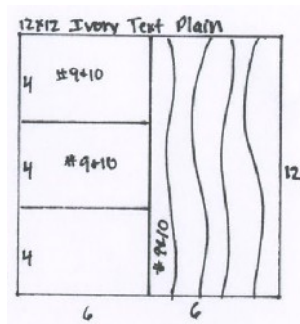

2. Cut the 8.5x11 Taupe Plain vertically at 4.25". Trim one 4.25x11 horizontally at 5.5". Cut the other 4.25x11 horizontally at 6.25".

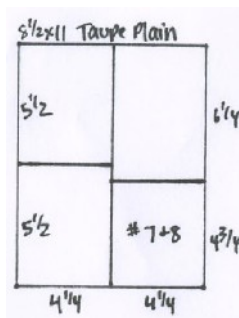

Layout #7 and #8



- 12x12 Ivory Print (L Base)
- 12x12 Taupe Print (R Base)
- 8.5x11 Taupe Plain
- (3) 4.25x6.25 Ivory Photo Mattes
- 4.25x6.25 Grey Photo Matte
- Ivory Text Cutaparts
- Ivory Text Die Cut
- Ivory Die Cut

1. Cut the 8.5x11 Taupe Plain vertically at 8 and 4". Trim each 4x11 horizontally at 6". Cut the 5x11 horizontally at 9.75 and 5.5".

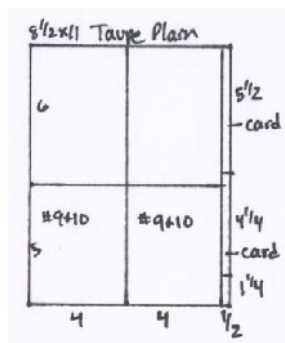

Layout #9 and #10

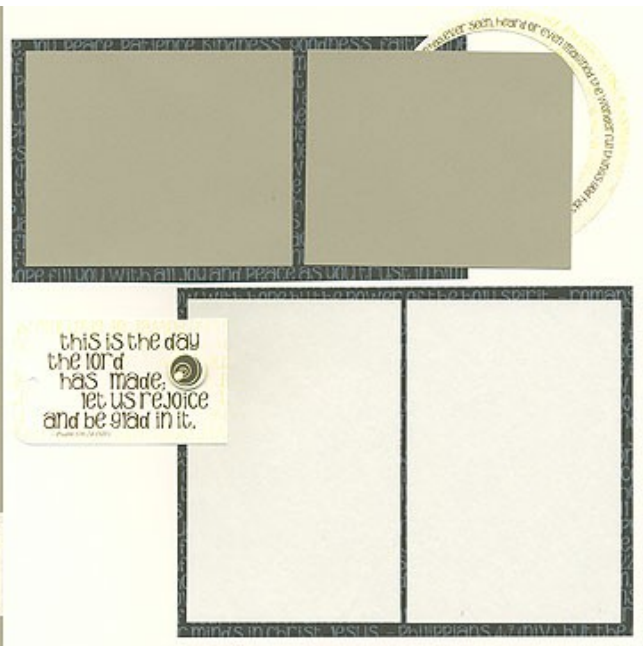

- 12x12 Taupe Print (L Base)
- 12x12 Ivory Plain (R Base)
- 8.5x11 Gray Print
- (2) 2.75x2.75 Ivory Plain (From #1-2)
- (2) 4x5 Taupe Plain (From #7-8)
- (2) 4x6 Ivory Text Plain (From #5-6)
- 2x12 Ivory Text Plain – Wave Cut (From #5-6)
- 4.25x6.25 Ivory Text Photo Matte
- Ivory Cutaparts
- Ivory Die Cuts
- Ivory Text Die Cuts

1. Cut the 8.5x11 Gray Print horizontally at 4.5”.

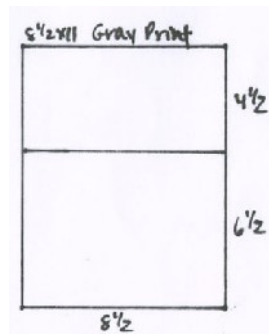

Card #1

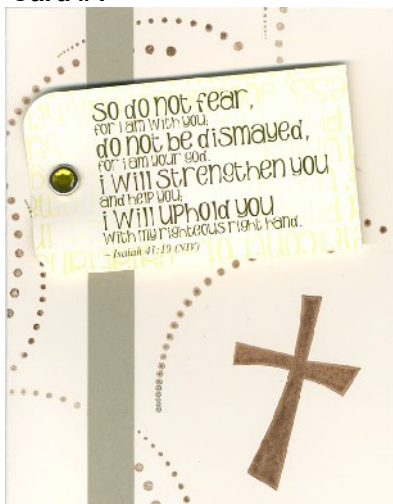

- 8.5x11 Ivory Plain
 - .5x5.5 Taupe Plain (From #7-8)
 - Ivory Die Cut: "Do Not Fear..."
 - Crystal Brad
 - UM Borders & Backgrounds
1. Cut the 8.5x11 Ivory Plain horizontally at 5.5". Fold each 5.5x8.5 in half to create a card.
 2. Stamp the front of the Ivory card with the UM images and Earth ink.
 3. Attach the narrow strip, Ivory tag and brad to the front of the card.

Card #2



- 4.25x8.5 Ivory Card (From Card #1)
 - .25x4.25 Taupe Plain (From #7-8)
 - Ivory Die Cuts
 - 6 Mini Brads
 - UM Borders & Backgrounds
1. Stamp the UM image onto the card with Sandstone ink. Attach the narrow strip to the card.
 2. Set the brads into the die cuts and attach with foam adhesive.

