

# Assembly Line Scrapbooking

## September 2009 Club Scrap® JR Birds of a Feather

### Materials:

- Birds of a Feather* CS® JR Kit

### Tools:

- 12" Paper Trimmer
- 3x13" CS® Grid Ruler
- Adhesive
- Tape
- CS® Fuchsia, Sapphire, and Onyx Ink

### *Fraction to Decimal Conversions*

$1/8" = .125"$     $1/2" = .5"$     $7/8" = .875"$

$1/4" = .25"$     $5/8" = .625"$

$3/8" = .375"$     $3/4" = .75"$

*The edges of many pages, photo mattes, and other elements have been edged with blue, pink, and black ink; however, instructions to do so are not included below.*



All rights reserved ©2009,  
Club Scrap, Inc.

(888) 634-9100 • [www.clubscrap.com](http://www.clubscrap.com) • email: [info@clubscrap.com](mailto:info@clubscrap.com)

Layout #1 and #2



- (2) 12x12 Green Plain
- 12x12 Periwinkle Print
- 12x12 Periwinkle Plain
- (2) 4.25x6.25 Green Print Photo Mattes
- Green Cutouts
- Wood Mounted Stamp
- Sapphire Ink
- Stickers

1. Trim the 12x12 Periwinkle Print at 7”.

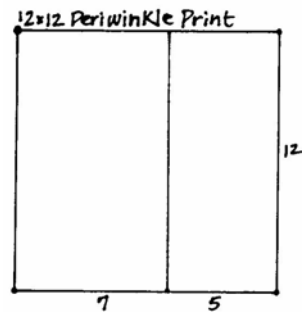

2. Cut the 12x12 Periwinkle Plain at 11, 9, and 6”. Trim the 6x12 horizontally at 8 and 4”. Cut the 3x12 horizontally at 9, 6, and 3”.

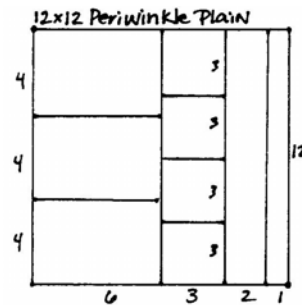

### Layout #3 and #4



- 12x12 White Print
- 12x12 Rose Plain
- (2) 4.25x6.25 Rose Plain Photo Mattes
- (2) 4.25x6.25 White Plain Photo Mattes
- 4.25x6.25 Green Plain Photo Matte
- Wood Mounted Stamp
- Fuchsia Ink
- Green and Rose Cutouts
- (4) Crystal Flowers

1. No trimming...enjoy!



### Layout #5 and #6

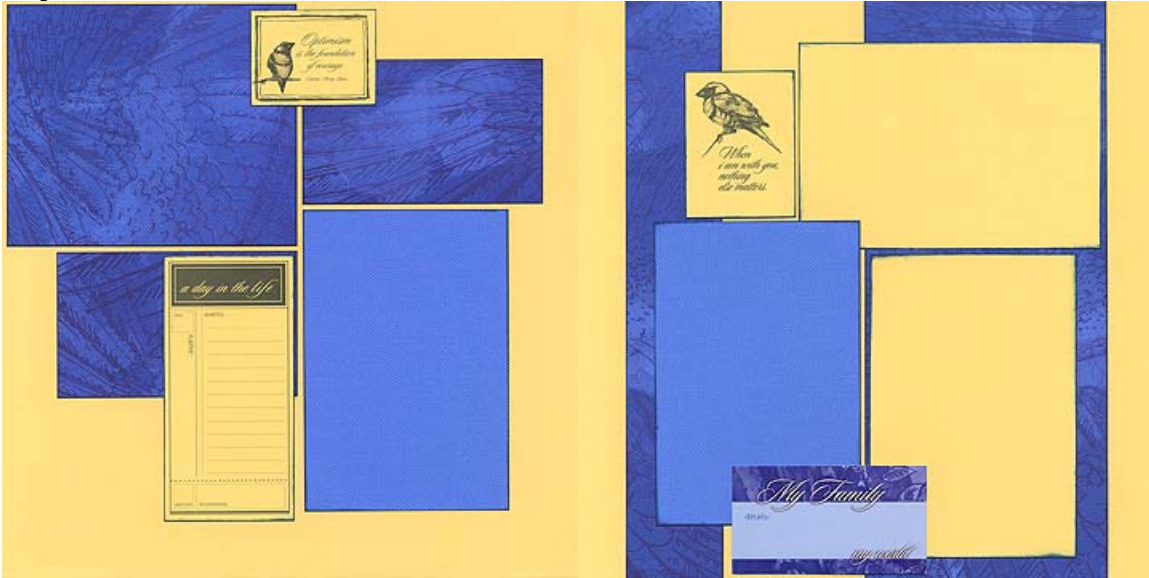

- (2) 12x12 Buttercup Plain
- 12x12 Periwinkle Print
- (2) 4.25x6.25 Periwinkle Plain Photo Mattes
- (2) 4.25x6.25 Buttercup Plain Photo Mattes
- Buttercup Cutouts
- Stickers

1. Trim the 12x12 Periwinkle Print at 10 and 5". Cut one 5x12 horizontally at 9 and 6".

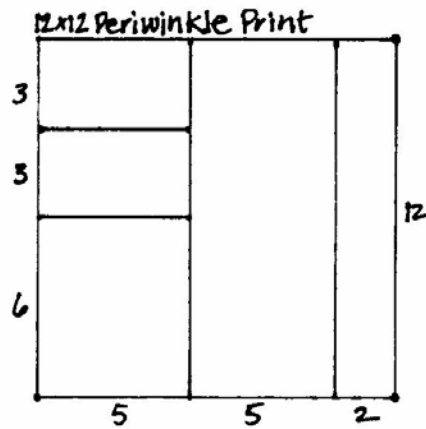

### Layout #7 and #8

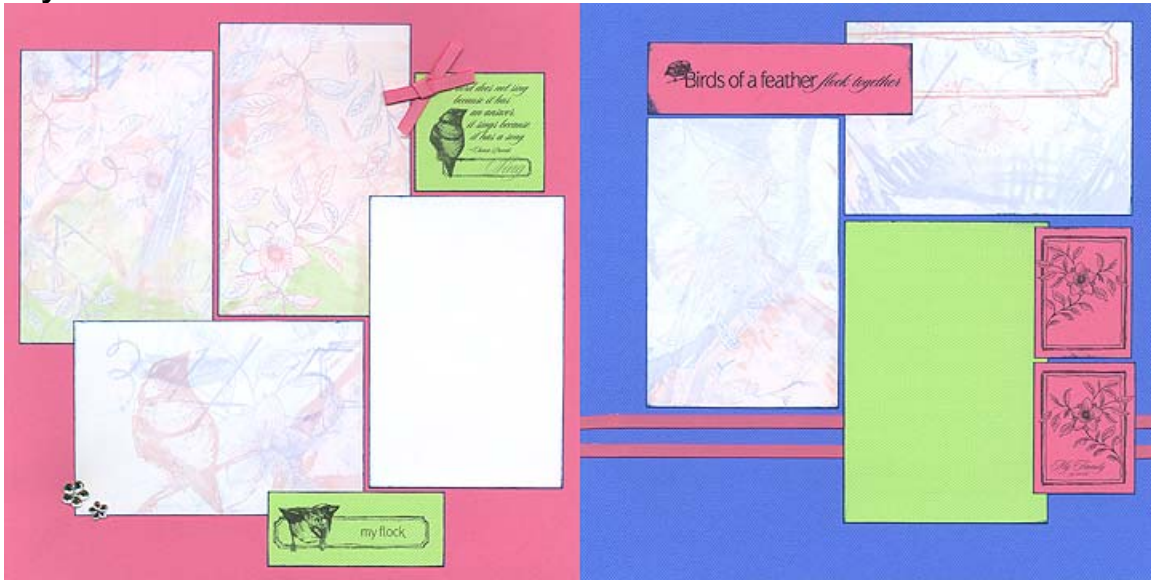

- 12x12 Rose Plain
- 12x12 Periwinkle Plain
- 12x12 White Print
- 4.25x6.25 Green Plain Photo Matte
- Green and Rose Cutouts
- Rose Grosgrain Fiber
- (2) Crystal Flowers

1. Trim the 12x12 White Print at 6". Cut each 6x12 at 8 and 4".

