

# Assembly Line Scrapbooking

## January 2009 Club Scrap® Gimme a Ring

### Materials:

- Gimme a Ring CS® Kit
- Gimme a Ring Embellishment Pack
- Gimme a Ring Wood Mounted Stamp Set

### Tools:

- 12" Paper Trimmer
- 13" CS® Grid Ruler
- Adhesive
- Glue Lines
- Tape
- Scissors
- Blue and Opaque White Ink
- Stylus Tool w/Blender Tip
- Paper Piercing Tool and Cork Board

### Fraction to Decimal Conversions

$1/8" = .125"$     $1/2" = .5"$     $7/8" = .875"$

$1/4" = .25"$     $5/8" = .625"$

$3/8" = .375"$     $3/4" = .75"$

*Note: We have incorporated items from the Embellishment Pack and Wood Mounted Stamps into many of this month's layouts. If you do not have all of these items, simply make a substitution or eliminate the step. To conserve paper or increase the number of layouts that can be created, substitute POPs for trimmed papers whenever possible.*



The edges of many pages, photo mattes, and other elements have been edged with blue ink; however, instructions to do so are not included below.

### Layout #1 and #2



- 12x12 Dark Maize Print
- 12x12 Light Maize Plain
- 12x12 Bisque Cover Plain
- 8.5x11 Dark Maize Print
- 8.5x11 Navy Plain
- 8.5x11 Bisque Text Plain
- 4.25x6.25 Dark Maize Photo Matte
- 4.25x6.25 Bisque Photo Matte
- Light and Dark Maize Cards
- Light Maize Tag
- Natural Twill
- Blue Ink
- Salutation Stencil

- Trim the 12x12 Light Maize Plain at 11.5, 11, and 7". Cut the 7x12 horizontally at 9.25 and 5". Trim the 4.25x7 horizontally at 6.25". Cut the 4x12 horizontally at 6".

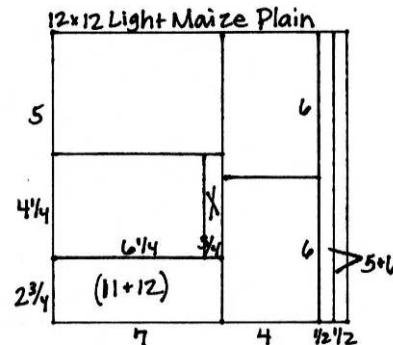

- Cut the 8.5x11 Navy Plain horizontally in half at 5.5".

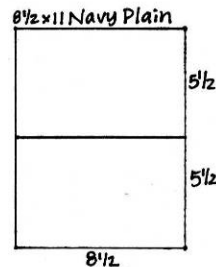

- Use the stylus tool to color the natural twill with blue ink.



Layout #3 and #4

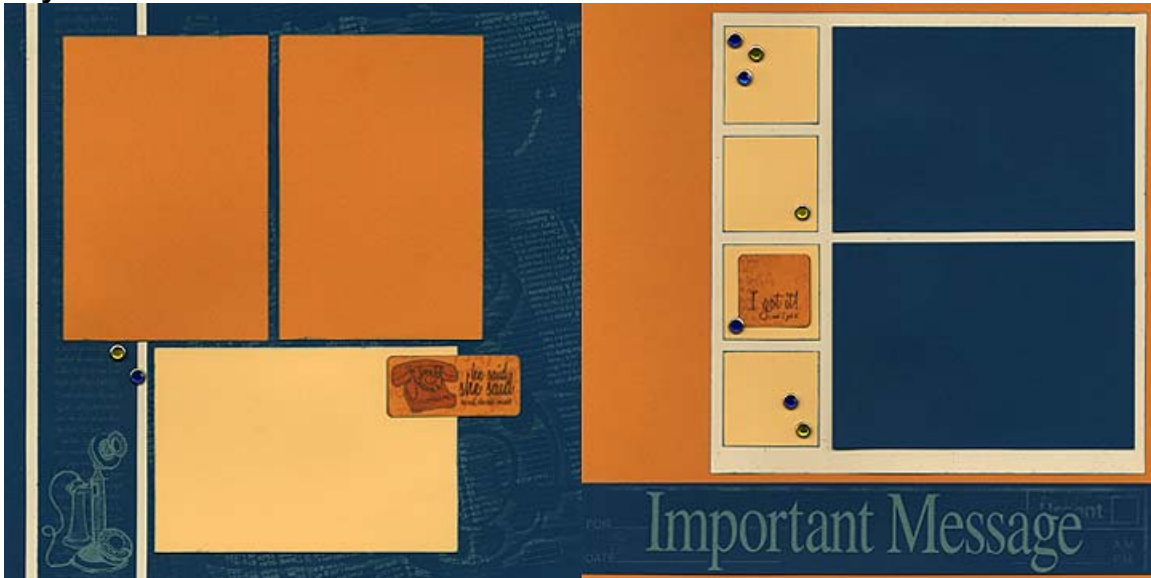

- 12x12 Navy Print
- 12x12 Dark Maize Plain
- 12x12 Bisque Text Plain
- 8.5x11 Light Maize Plain
- (2) 4.25x6.25 Dark Maize Photo Mattes
- (5) Navy Jewel Brads
- (4) Yellow Jewel Brads
- (2) Printed Navy Title Strips
- Dark Maize Die Cuts

1. Trim the 12x12 Bisque Text Plain at 9.5". Cut the 9.5x12 horizontally at 9".

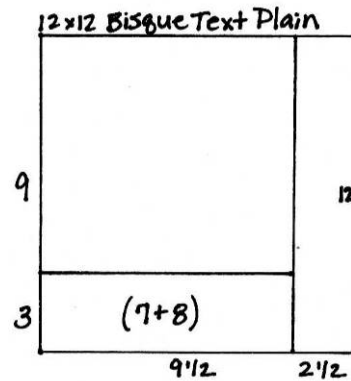

2. Cut the 8.5x11 Light Maize Plain horizontally at 9 and 6.25". Trim the 6.25x8.5 horizontally at 4.25". Cut the 2x8.5 horizontally at 8, 6, 4, and 2".

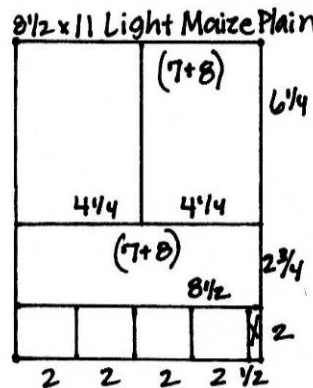

Layout #5 and #6



- 12x12 Light Maize Print
- 12x12 Navy Plain
- 12x12 Bisque Text Plain
- 8.5x11 Dark Maize Print
- 8.5x11 Navy Plain
- (2) .5x12 Light Maize Plain (From Layout #1 and #2)
- (2) 4.25x6.25 Light Maize Photo Mattes
- 4.25x6.25 Bisque Photo Matte
- Black Ric Rac Fiber
- Printed Navy Title Strip
- Wood Mounted Stamp
- Light Maize Tags
- Dark Maize Die Cuts
- Dark Maize Cards

1. Trim the 12x12 Bisque Text Plain at 8".

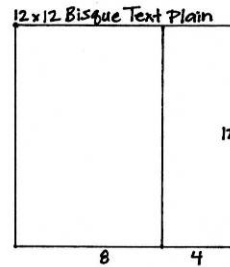

2. Cut the 8.5x11 Dark Maize Print vertically at 5.5". Trim the 3x11 horizontally at 9, 6, and 3".

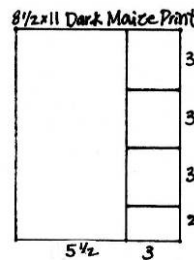

3. Trim the 8.5x11 Navy Plain horizontally at 10 and 6". Cut the 6x8.5 horizontally at 8 and 4". Trim the 4x8.5 horizontally at 6".

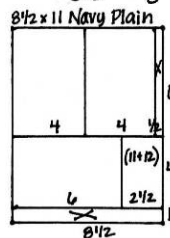

Layout #7 and #8

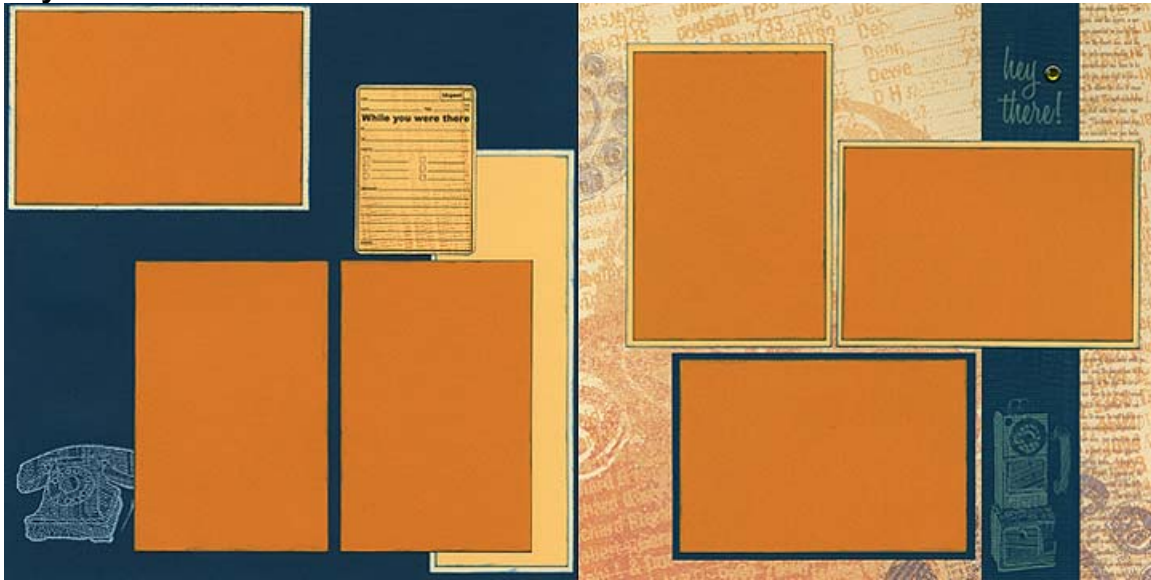

- 12x12 Bisque Cover Print
- 12x12 Navy Plain
- 12x12 Dark Maize Plain
- 2.75x8.5 Light Maize Plain (From Layout #3 and #4)
- 3x9.5 Bisque Text Plain (From Layout #3 and #4)
- 4.25x6.25 Light Maize Plain (From Layout #3 and #4)
- 4.25x6.25 Light Maize Photo Matte
- 4.25x6.25 Bisque Photo Matte
- 4.25x6.25 Navy Photo Matte
- Light Maize Card
- Wood Mounted Stamp
- Printed Navy Title Strip
- Yellow Jewel Brad
- White Ink

1. Trim the 12x12 Dark Maize Plain at 6". Cut each 6x12 horizontally at 8 and 4".

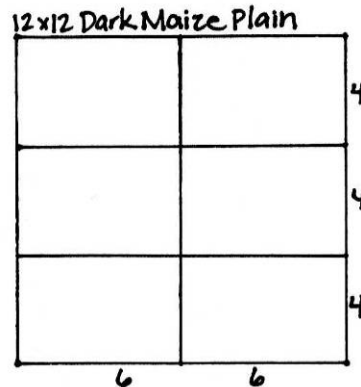

2. Cut the 3x9.5 Bisque Text Plain horizontally at 8.75".

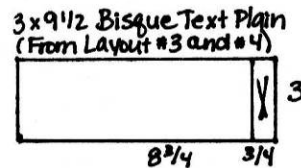

Layout #9 and #10



- 12x12 Bisque Cover Print
- 12x12 Dark Maize Print
- 12x12 Light Maize Plain
- 8.5x11 Bisque Text Plain
- 8.5x11 Navy Print
- Small Wood Mounted Stamp
- (2) Navy Jewel Brads
- (2) Printed Navy Title Strips
- Ginger Grosgrain Ribbon
- Orange Polka Dot Ribbon

1. Trim the 12x12 Light Maize Plain at 10 and 5". Cut each 5x12 horizontally at 8 and 4". Trim two 4x5 pieces horizontally at 2.5".

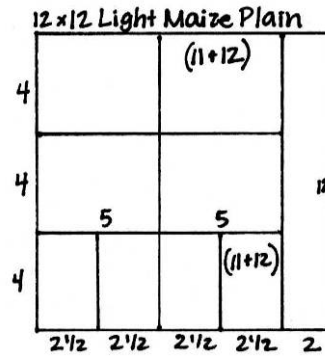

2. Cut the 8.5x11 Navy Print horizontally at 6.25". Trim the 6.25x8.5 horizontally at 4.25". Cut the 4.75x8.5 horizontally at 7.5 and 3.75".

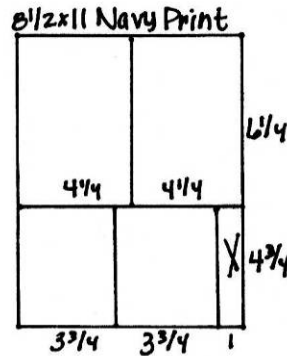

Layout #11 and #12



- 12x12 Navy Print
- 12x12 Bisque Cover Plain
- 12x12 Light Maize Print
- 8.5x11 Navy Print
- 8.5x11 Light Maize Plain
- 2.5x4 Light Maize Plain (From Layout #9 and #10)
- 2.5x4 Navy Plain (From Layout #5 and #6)
- 2.75x7 Light Maize Plain (From Layout #1 and #2)
- 4x5 Light Maize Plain (From Layout #9 and #10)
- Dark Maize Die Cuts
- Printed Navy Title Strip
- Ginger Grosgrain Ribbon
- Navy Curly Cue Cord
- Dark Maize Card
- Salutation Stencil

1. Place the 12x12 Light Maize Print into the trimmer as shown, and trim at 8".

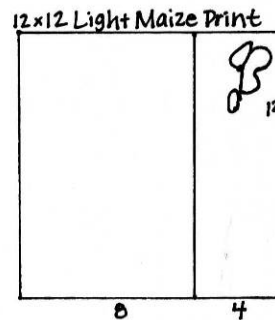

2. Cut the 8.5x11 Light Maize Plain horizontally at 10.5 and 6.25". Trim the 6.25x8.5 horizontally at 4.25". Cut the 4.25x8.5 horizontally at 6.25". Trim the 2.25x4.25 horizontally at 3.75".

